

VALLEY VIEW MANOR

*Managed by The Evangelical
Lutheran Good Samaritan Society*

*F*loor plan

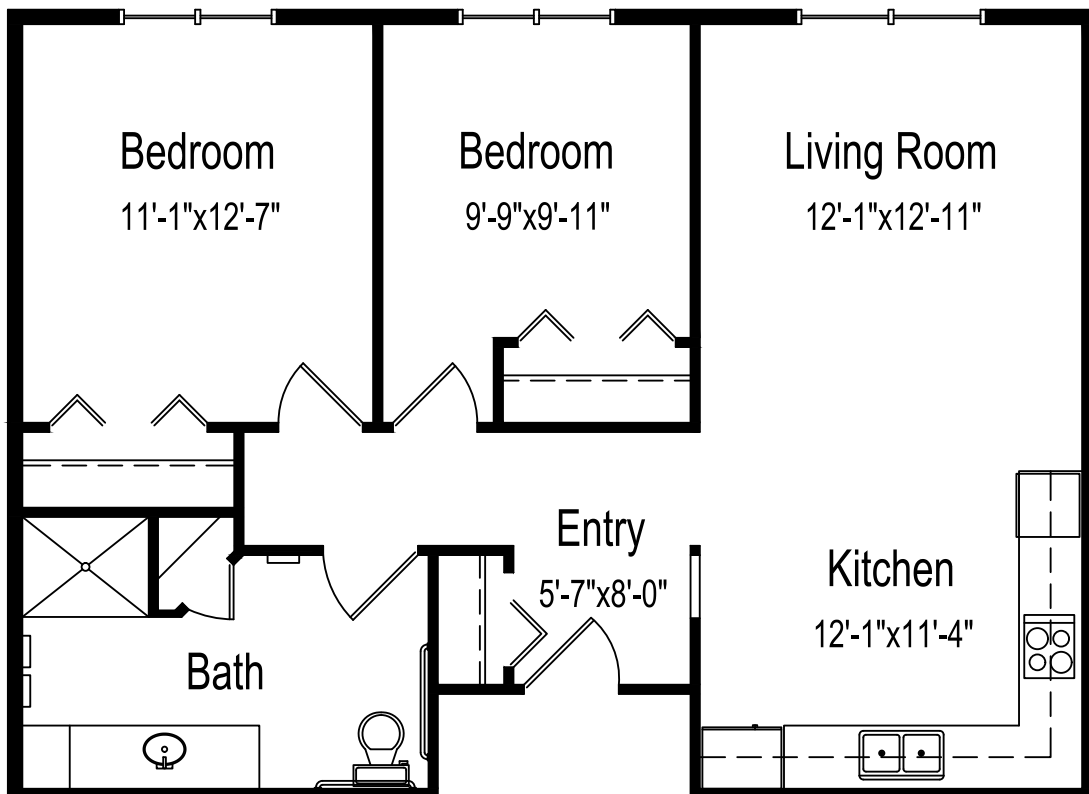

Two bedroom, one bath

834 sq. ft.

(Dimensions and square footage may vary)

302 Main St S • Velva, ND 58790 • (701) 338-2727 • good-sam.com/sourisvalley



The Evangelical Lutheran Good Samaritan Society (the Society) and Owner comply with applicable Federal civil rights laws and does not discriminate against any person on the grounds of race, color, national origin, disability, familial status, religion, sex, age, sexual orientation, gender identity, gender expression, veteran status or other protected statuses except as permitted by applicable law, in admission to, participation in, or receipt of the services and benefits under any of its programs and activities, and in staff and employee assignments to individuals, whether carried out by the Society directly or through a contractor or any other entity with which the Society arranges to carry out its programs and activities. All faiths or beliefs are welcome. This institution is an equal opportunity provider and employer. © 2018 The Evangelical Lutheran Good Samaritan Society. All rights reserved. ATENCIÓN: si habla español, tiene a su disposición servicios gratuitos de asistencia lingüística. Llame al 1-866-477-5343. ACHTUNG: Wenn Sie Deutsch sprechen, stehen Ihnen kostenlos sprachliche Hilfsdienstleistungen zur Verfügung. Rufnummer: 1-866-477-5343. 181717